



REU-AM – PCD01W Pipe Cover

Installation Instruction

GENERAL INFORMATION

This Pipe cover (PCD01W) is compatible with Rinnai Water Heater models as listed on the right.

- For your safety, always wear safety glasses and gloves.
- To use this product correctly and safely, please read and follow these assembly and installation instructions.
- Carefully unpack and identify each component before attempting to assemble. Refer to Parts List.
- The pipe cover is designed to conform with the hot water heater and is approximately the same width and depth of the appliance. An installed pipe cover conceals 460mm of pipework below the appliance.

MODELS	
Infinity 12	REU-AM1220WD
Infinity 16	REU-AM1620WD
Infinity 20	REU-AM2024WD
Infinity 26	REU-AM2626WD

PIPE COVER PCD01 PARTS LIST

Part No.	Description	Quantity
①	Top Frame	1
②	Bottom Frame	2
③	Left Panel	1
④	Right Panel	1
⑤	Front Panel	1
⑥	L Bracket	2
⑦	Plastic Retaining Clip	2
⑧	Screw M4x12	4 *
⑨	Screw M4x8	6
⑩	Plastic Washer M4	10 *
⑪	Screw M5x8	2
⑫	Wall Anchor	2
⑬	Screw diam. 4.8x32	2



* For Australia & New Zealand only. To meet AS/NZS 5601 access requirements, the four M4x12 screws ⑧ and four of the M4 plastic washers ⑩ are not to be fitted.

① INITIAL ASSEMBLY

1. Assemble the top frame ① to the left ③ and right ④ panels with the plastic retaining clips ⑦. Once in place secure these parts with screws ⑨ and plastic washers ⑩.
2. Secure the two bottom frames ② to the left ③ and right ④ panels with screws ⑨ and plastic washers ⑩.

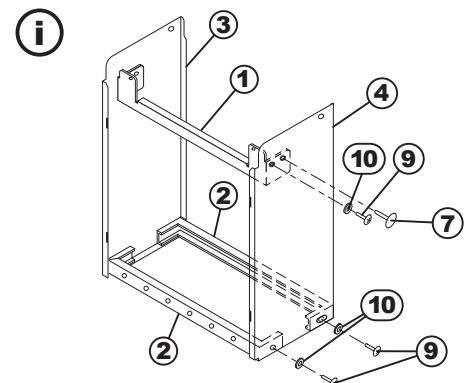

ii APPLIANCE PREPARATION

1. Remove the four mounting screws **(A)** and **(B)** from the bottom and sides of the appliance.
2. Install the two L brackets **(6)** to the bottom of the appliance with the four mounting screws **(A)** removed in step 3 using the two outermost of the four holes, ensure that the tabs of the L brackets are facing towards the rear of the appliance.

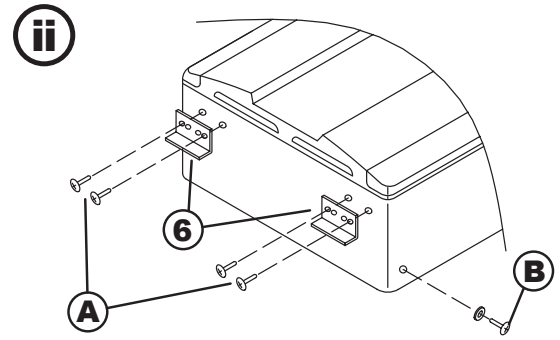

iii PIPE COVER INSTALLATION

3. Temporarily fit the pipe cover assembly into the bottom of the appliance, using the side mounting holes with the screws **(B)** that were removed from the appliance sides in step 3. **DO NOT** fully re-tighten these screws as they will be removed again in step 8.
4. Loosen the screws of the 'rear' bottom frame **(2)** and move the frame into its final position. Once satisfied re-tighten screws.
5. Select two suitable fixing points through the 'rear' of the bottom frame **(2)** and mark off their position on the wall.
6. Remove the pipe cover assembly from the appliance and drill two holes in the wall as marked. If using the wall anchors **(12)** supplied, a 5mm (0.2 inch) diameter hole to a depth of 25mm (1 inch) is required.
7. Gently tap the wall anchors **(12)** into the drilled holes until flush with the wall surface.
8. Refit and secure the pipe cover assembly onto the bottom of the appliance using the side mounting holes and screws **(8)**.

Secure the top frame **(1)** of the pipe cover assembly to the appliance via the L brackets **(6)** with two screws **(11)**.

9. Secure the pipe cover to the wall through the 'rear' bottom frame **(2)** with two screws **(13)**.

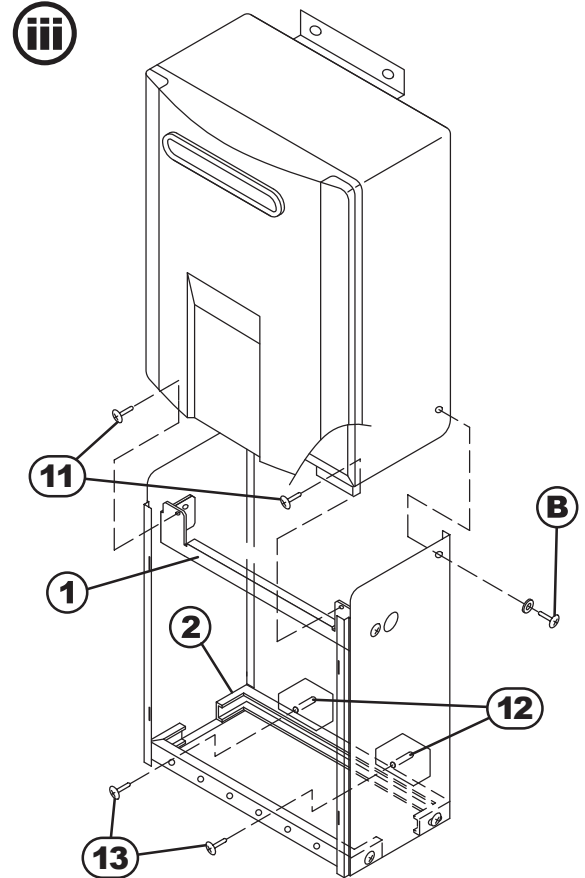

iv FITTING FRONT PANEL

10. Attach the front panels **(5)** to the pipe cover assembly by inserting the four tab hooks **(C)** into the slots **(D)** of the left **(3)** and right **(4)** panels (see tab hook and slot detail below).

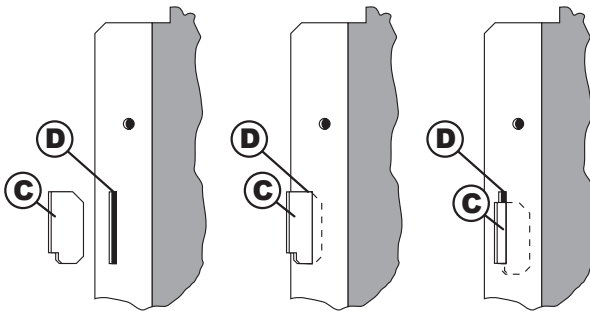

11. Open the small hinged panels on the top and bottom of the plastic side trims. Remove the retaining clips and discard. Slide the front panel upwards in the slots **(D)** and fasten in place using the screws* **(8)** and washers* **(10)**.

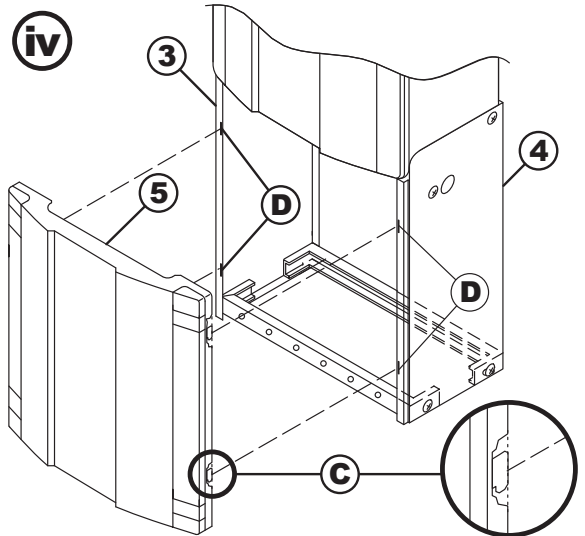

*** For Australia & New Zealand ONLY. To meet AS/NZS 5601 access requirements, the four M4x12 screws **(8)** and four of the M4 plastic washers **(10)** are **NOT** to be fitted.**

Rinnai Australia Pty Ltd

ABN 74 005 138 769 AU45204
100 Atlantic Drive, Keysborough, Victoria 3173
P.O. Box 460, Braeside, Victoria 3195
Tel: (03) 9271 6625

National Help Line
Tel: 1300 555 545*

Hot Water Service Line
Tel: 1800 000 340*